

PAL Series

Male-Male Adaptor

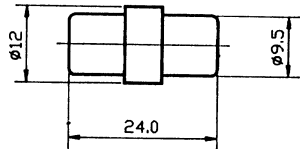

110360 PAL-01-DNN



Female-Female Adaptor

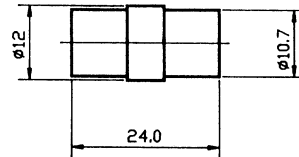

110366 PAL-04-DNN



PAL Female-F Male Adaptor

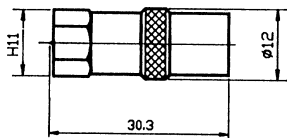

110362 PAL-02-DNN



PAL Female-F Female Adapt.

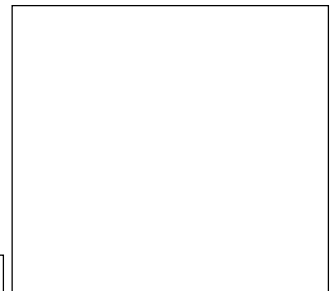

110368 PAL-05-DNN

PAL Male-F Male Adaptor

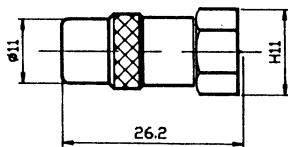

110364 PAL-03-DNN



PAL Male-F Female Adapt.

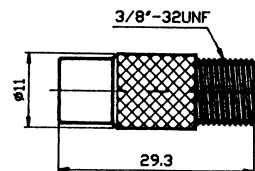

110370 PAL-06-DNN

