



SMB/MINI-SMB Series

SMB/MINI-SMB

SMB (Sub-Miniature-B) series incorporates a “Snap On” latching action, which provides rapid and easy connections. The impedance of this series can be controlled at 50 ohms & 75 ohms (the 75 ohm version is also known as MINI-SMB connector), and it can be operated respectively up to 4GHz and 2GHz. The SMB is suitable for the standard ranges of flexible & semi-rigid cables, and it is also available as a PCB mounted version.

Applications:

- *test and measurement
- *instrumentation
- *telecommunications
- *video systems
- *PC/LAN
- *microwave components
- *base stations
- *radio boards
- *wireless

Interface dimensions conformable to the Standards:

International: IEC 169-10

USA: MIL-C-39012

SMB 50Ω Interface Dimensions:

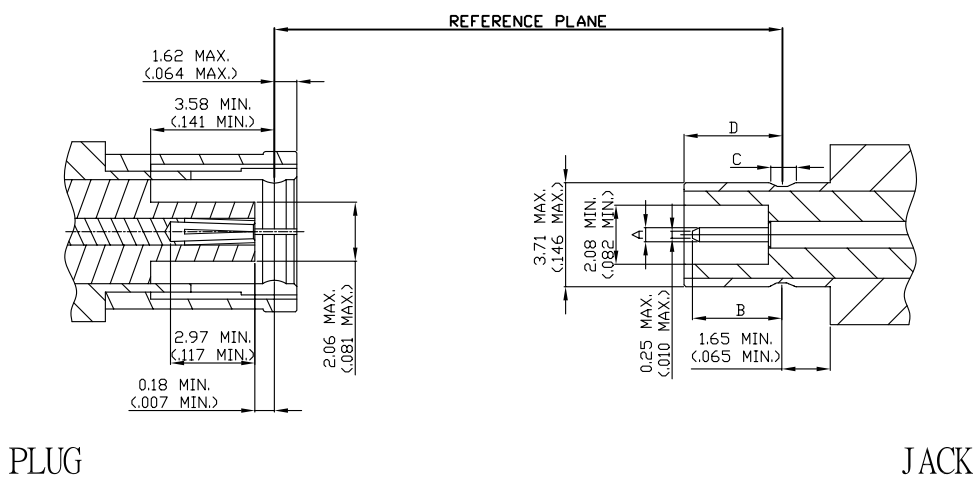

SMB Series						
PLUG			JACK			
	Minimum	Maximum		Minimum	Maximum	
				0.48(.019)	0.53(.021)	A
				2.39(.094)	2.97(.117)	B
				0.69(.027)	0.94(.037)	C
				3.33(.131)	3.58(.141)	D

*Millimeters(Inches)



Materials :

Connector part	Material	Finish
Bodies	Brass	Nickel or Gold
Center Contact	Male: Brass Female: Beryllium copper	Gold
Insulator	Teflon	N/A
Crimp ferrule	Annealed copper	Nickel or Gold

Electrical :

Electrical Data	Detail		
Impedance	50 ohm		
Frequency range	0~4 GHz		
Working voltage	RG178/U → 250 volts rms max. at sea level RG316/U, 405 → 335 volts rms max. at sea level		
Insulation resistance	1,000 megohms min.		
Dielectric withstanding voltage	RG178/U → 750 volts rms min. at sea level RG316, 405 → 1,000 volts rms min. at sea level		
Contact resistance	Center contact: 6 milliohms max. Outer contact: 2.5 milliohms max.		
VSWR: f (GHz)		Straight	Right angle
	RG178/U	1.3+0.04f	1.45+0.06f
	RG316/U, 405	1.25+0.04f	1.35+0.04f
Insertion loss	0.3dB max. (straight) 0.6dB max. (right angle)		

Mechanical :

Mechanical Data	Detail
Engagement force	14 lbs max.
Disengagement force	14 lbs max.
Connector durability	500 cycles min.
Cable retention force	RG178/U → 10 lbs
	RG316/U → 20 lbs
	RG405 → 30 lbs

Environmental :

Environmental Data	Detail
Corrosion (Salt spray)	MIL-STD-202 METHOD 101 CONDITION B
Thermal shock	MIL-STD-202 METHOD 107 CONDITION B
Vibration	MIL-STD-202 METHOD 204 CONDITION B
Mechanical shock	MIL-STD-202 METHOD 213 CONDITION B

SMB STRAIGHT PLUG FOR CABLE TYPE

CRIMP FOR FLEXIBLE CABLE

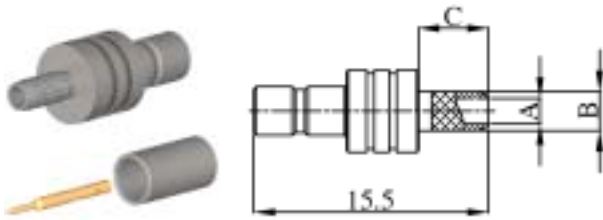

PART NUMBER	A	B	C	CABLE TYPE(RG/U)
SMB-01LV1-TGG	1.7	2.7	5.0	174 , 188A , 316
SMB-01M-TGG	1.0	2.0	5.0	178 , 196
SMB-01N-TGG	1.7	2.7	5.0	179B,187A

SOLDER FOR SEMI-RIGID CABLE

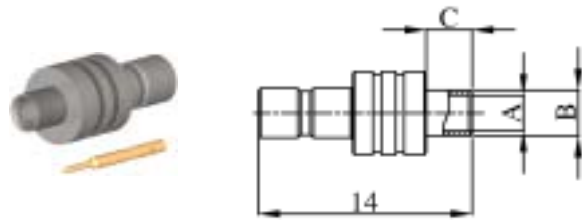

PART NUMBER	A	B	C	CABLE TYPE(RG/U)
SMB-01V1-TGG	2.3	3.0	3.3	RG405U(.085")
SMB-01V3-TGG	1.4	2.2	3.3	UT-47(.047")

SMB STRAIGHT JACK FOR CABLE TYPE

CRIMP FOR FLEXIBLE CABLE

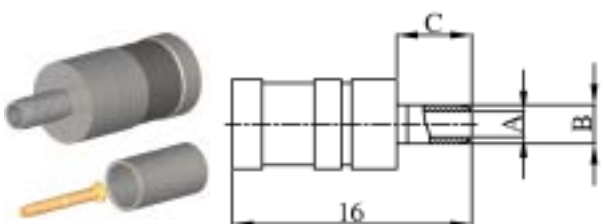

PART NUMBER	A	B	C	CABLE TYPE(RG/U)
SMB-02LV1-TGG	1.7	2.7	5.0	174 , 188A , 316
SMB-02M-TGG	1.0	2.0	5.0	178 , 196
SMB-05N-TGG	1.7	2.7	5.0	179B,187A

SOLDER FOR SEMI-RIGID CABLE

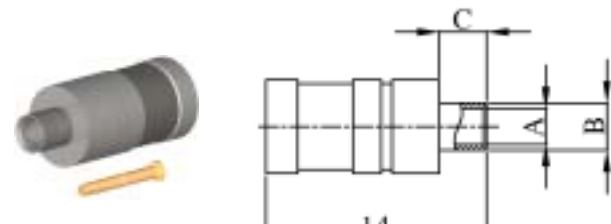

PART NUMBER	A	B	C	CABLE TYPE(RG/U)
SMB-02V1-TGG	2.3	3.0	3.3	RG405U(.085")
SMB-02V3-TGG	1.4	2.2	3.3	UT-47(.047")

SMB STRAIGHT PLUG BULKHEAD FOR CABLE TYPE

CRIMP FOR FLEXIBLE CABLE

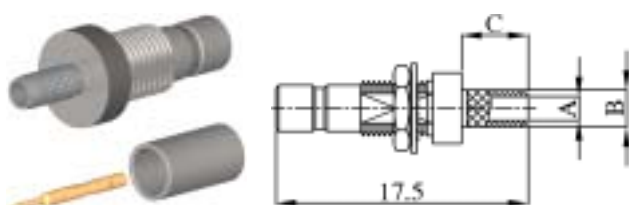

PART NUMBER	A	B	C	CABLE TYPE(RG/U)
SMB-05LV1-TGG	1.7	2.7	5.0	174 , 188A , 316
SMB-05M-TGG	1.0	2.0	5.0	178 , 196
SMB-05N-TGG	1.7	2.7	5.0	179B,187A

SOLDER FOR SEMI-RIGID CABLE

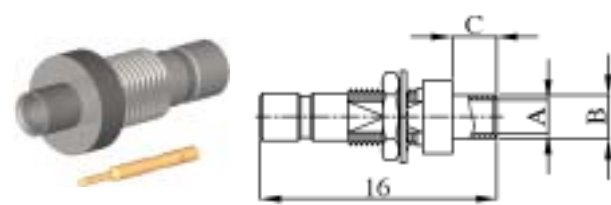

PART NUMBER	A	B	C	CABLE TYPE(RG/U)
SMB-05V1-TGG	2.3	3.0	3.3	RG405U(.085")
SMB-05V3-TGG	1.4	2.2	3.3	UT-47(.047")

TGN : IEFロン INSULATION + GOLD PLATED CONTACT + NICKEL PLATED BODY
 TGG : IEFロン INSULATION + GOLD PLATED CONTACT + GOLD PLATED BODY



SMB RIGHT ANGLE PLUG FOR CABLE TYPE

CRIMP FOR FLEXIBLE CABLE

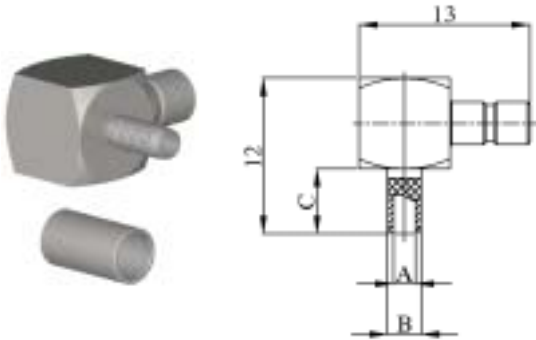

PART NUMBER	A	B	C	CABLE TYPE(RG/U)
SMB-08LV1-TGG	1.7	2.7	5.0	174 , 188A , 316
SMB-08M-TGG	1.0	2.0	5.0	178 , 196
SMB-08N-TGG	1.7	2.7	5.0	179B,187A

SOLDER FOR SEMI-RIGID CABLE

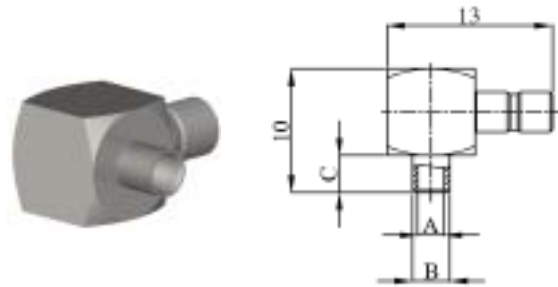

PART NUMBER	A	B	C	CABLE TYPE(RG/U)
SMB-08V1-TGG	2.3	3	3.3	RG405U(.085")
SMB-08V3-TGG	1.4	2.2	3.3	UT-47(.047")

SMB RIGHT ANGLE JACK FOR CABLE TYPE

CRIMP FOR FLEXIBLE CABLE

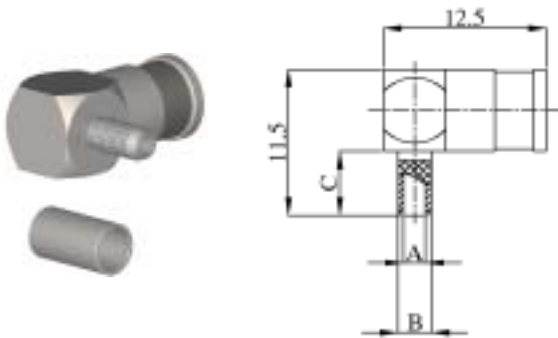

PART NUMBER	A	B	C	CABLE TYPE(RG/U)
SMB-03LV1-TGG	1.7	2.7	5	174 , 188A , 316
SMB-03M-TGG	1.0	2.0	5	178 , 196
SMB-03N-TGG	1.7	2.7	5.0	179B,187A

SOLDER FOR SEMI-RIGID CABLE

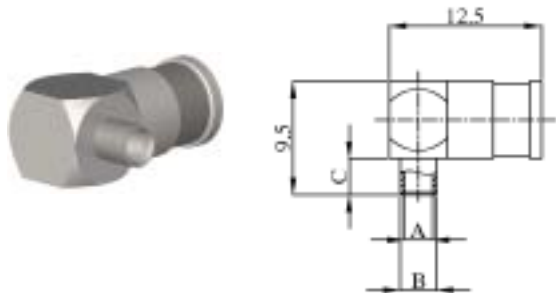

PART NUMBER	A	B	C	CABLE TYPE(RG/U)
SMB-03V1-TGG	2.3	3	3.3	RG405U(.085")
SMB-03V3-TGG	1.4	2.2	3.3	UT-47(.047")

SMB STRAIGHT PLUG PCB RECEPTACLE

SURFACE MOUNT

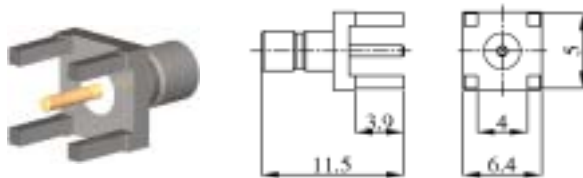

PART NUMBER	SMB-10-TGG(-75)
-------------	-----------------

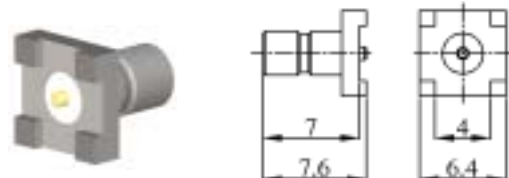

PART NUMBER	SMB-10V4-TGG(-75)
-------------	-------------------

TGN : IEFロン INSULATION + GOLD PLATED CONTACT + NICKEL PLATED BODY
 TGG : IEFロン INSULATION + GOLD PLATED CONTACT + GOLD PLATED BODY
 75 : 75OHM

SMB STRAIGHT PLUG PCB END LAUNCH RECEPTACLE

END LAUNCH

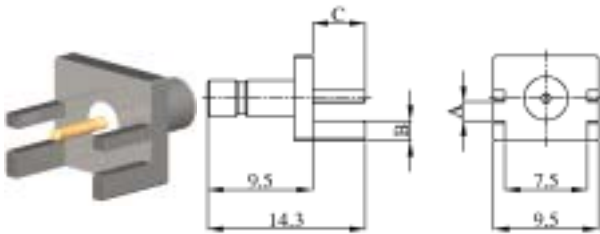

PART NUMBER	BOARD THICKNESS	A	B	C
SMB-10V5-TGG(-75)	1.57	1.73	1.22	0.48

SMB STRAIGHT JACK PCB RECEPTACLE

SURFACE MOUNT

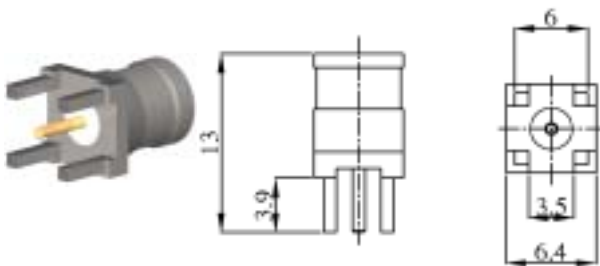

PART NUMBER	SMB-11-TGG(-75)

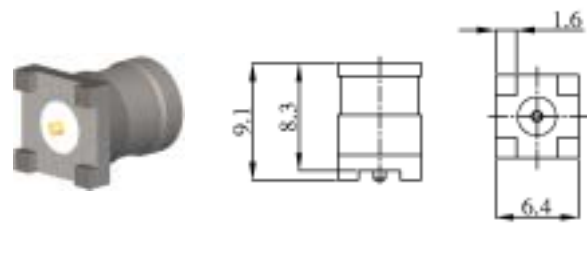

PART NUMBER	SMB-11V4-TGG(-75)

SMB RIGHT ANGLE PLUG PCB MOUNT

SURFACE MOUNT

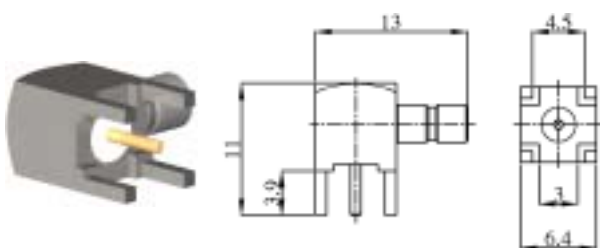

PART NUMBER	SMB-07-TGG(-75)

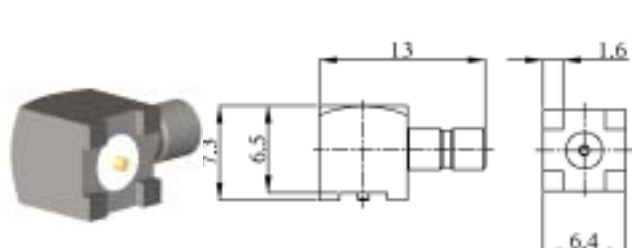

PART NUMBER	SMB-07V4-TGG(-75)



SMB RIGHT ANGLE JACK PCB MOUNT

SURFACE MOUNT

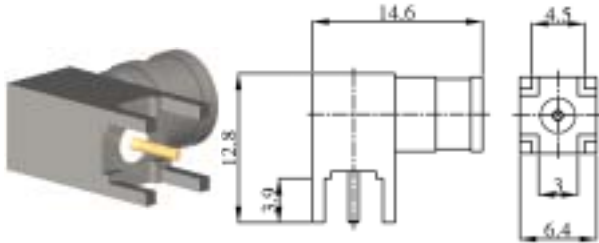

PART NUMBER	SMB-06-TGG(-75)
-------------	-----------------

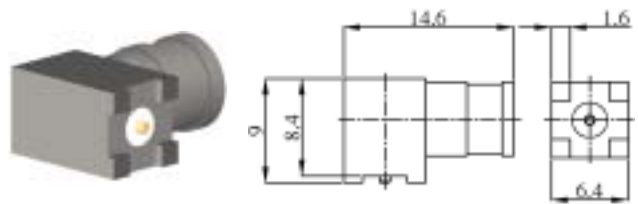

PART NUMBER	SMB-06V4-TGG(-75)
-------------	-------------------

SMB STRAIGHT PLUG BULKHEAD RECEPTACLE

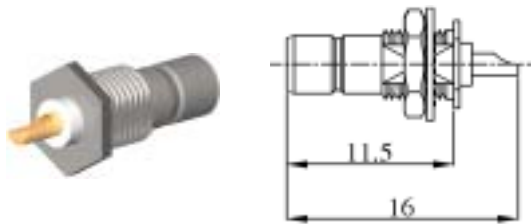

PART NUMBER	SMB-17-TGG(-75)
-------------	-----------------

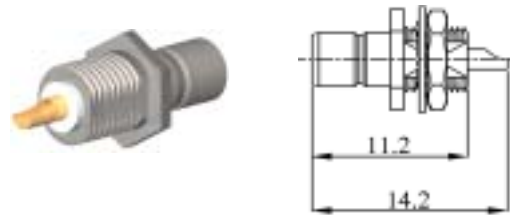

PART NUMBER	SMB-17V4-TGG(-75)
-------------	-------------------

PRESS-IN

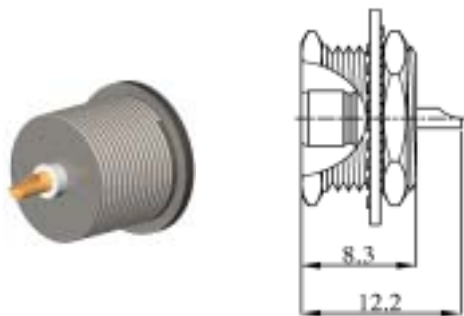

PART NUMBER	SMB-13-TGG(-75)
-------------	-----------------

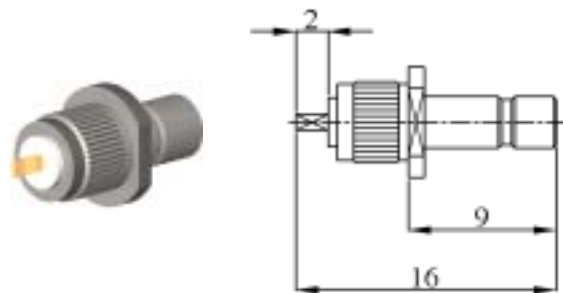

PART NUMBER	SMB-17V5-TGG(-75)
-------------	-------------------

TGN : IEFロン INSULATION + GOLD PLATED CONTACT + NICKEL PLATED BODY
 TGG : IEFロン INSULATION + GOLD PLATED CONTACT + GOLD PLATED BODY
 75 : 75OHM

SMB PLUG 2 HOLES FLANGE MOUNT

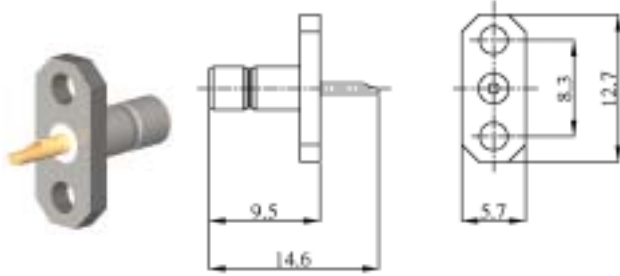

PART NUMBER	SMB-12-TGG(-75)
-------------	-----------------

SMB PLUG 4 HOLES FLANGE MOUNT

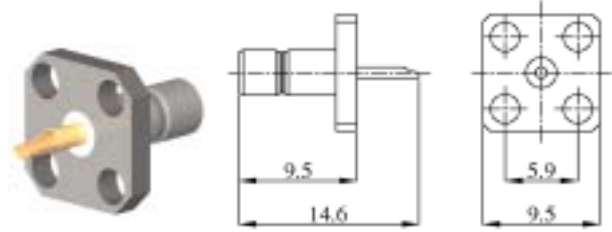

PART NUMBER	SMB-18-TGG(-75)
-------------	-----------------